

Committee(s):	Date(s):	
<b>Hampstead Heath Consultative Committee</b>	8 <sup>th</sup> July 2013	
Subject: <b>Progress Report on Sustainable Planting in the Walled Garden - Golders Hill Park</b>	Public	
Report of: <b>Superintendent of Hampstead Heath</b>	For Discussion	
<p style="text-align: center;"><b><u>Summary</u></b></p> <p>This report updates members on the implementation of phase one of the sustainable perennial permanent plantings in the Walled Garden at Golders Hill Park.</p> <p>The report also updates members on the progress of phase two of the planting programme and outlines the on-going cyclical horticulture maintenance requirements.</p> <p><b>Recommendation</b></p> <p>Consultative Committee notes the successful implementation of the sustainable planting to replace season bedding planting schemes and the associated cost savings.</p>		

## **Main Report**

### **Introduction**

1. The Walled Garden in Golders Hill Park has been a formal flower garden for more than a century. Post Second World War it has been used to display spring and summer bedding planting schemes, common throughout many local authority parks and gardens in the United Kingdom.
2. As part of the City's efficiency savings that formed the basis of reports to your Committee in February and July 2011, reduction of seasonal bedding in Golders Hill Park was identified as reversible cost saving achieving on-going savings of £55,000 per annum by the end of 2013/14. The move to more sustainable planting is reversible if the economic climate was to change.

### **Proposals**

3. In late 2011 your Committee endorsed the following vision for a perennial sustainable planting scheme:

*“A strong formal structure using a mix of evergreen topiary, hedging and trees which will provide a framework for colour provided by the grasses, roses and herbaceous planting”.*
4. This vision acknowledged the need to continue to provide seasonal horticultural interest, whilst moving to sustainable perennial plants to give a colour, structure and food source for bees, butterflies and other insects for as long a season as possible.

5. Although initially skeptical about the proposed changes, staff, led by the Head Gardener from the Hill Garden Pergola, embraced the concept of new perennial planting and were heavily involved in preparing concept planting plans, plant list palette. An artist's impressions of the proposals was produced and put on public display in strategic locations in Golders Hill Park (see Appendix 1).

#### Phase 1 - Planting Season 2012

5. A phased approach of two years implementation program was set so that the public would see the benefits of the historical change from seasonal bedding to perennial sustainable planting. For the 2012 London Olympics a third of the summer seasonal bedding was retained to provide colour during the first growing season.
6. The front (170 m<sup>2</sup>) and west wall border (60 m<sup>2</sup>) were planted with sustainable perennials during the spring of 2012. Although the spring and summer seasons were unseasonable wet, the plants established and produced a fine successful display in the first year see photographs at Appendix 2.
7. Structured plants of cubed *Buxus semperivens* (Box) and *Quercus ilex* (Evergreen Oak) clipped trees were planted out in all the borders. These provided the main structure or "framework" of the scheme and create added interest in the winter and early spring.

#### **Current Position**

#### Phase 2 – Planting Season 2013

8. In the spring of 2013 the remaining nine borders totaling (406 m<sup>2</sup>) were planted with sustainable perennial plants. The nine borders were prepared utilising bulky leaf compost which is brought on in the recycling area in Golders Hill Park.
9. Winter and spring flowering bulbs were planted in all the borders to add seasonal interest. A copy of the planting list is provided at Appendix 3.
10. Ongoing review of the phase 1 planting of the front and west borders and each individual bay within those borders is essential. The gardening team monitor and identify areas where they need to reduce the number of plants in a bay to prevent overcrowding, or increasing the number of plants to improve the visual impact. Some minor alterations to the front border have already have been implemented as a result of this review process.
11. In the summer of 2013, small pockets of traditional summer bedding plants such as *Trachelium* and *Dahlia* will be planted in the nine borders. The plants will be supplied by West Ham Park Nursery.

#### Horticulture Maintenance

12. The management of sustainable perennial planting schemes requires craft level horticulture skills and knowledge. The maintenance works are carried out by the gardening team based in Golders Hill Park. The following outlines the cyclical maintenance programme:

### Spring & Summer

- Application of mulch - moisture retention and weed control
- Weed, pest and disease control - using non-chemical methods
- Application of organic fertiliser
- Staking - to support plants
- Irrigation - as required
- Dead-heading - to encourage a longer flowering season
- Answering public questions and providing advice

### Autumn & Winter

- Dead-heading
- Cutting & pruning back
- Lifting & dividing plants

### **Consultation**

13. The risk associated in the change from the historical seasonal bedding displays prevalent in Golders Hill Park for many years to sustainable planting did not cause a public outcry. Gardening staff have received many positive verbal comments and a senior member of staff from the HFL commented by e-mail on 24 September 2012:

*"I was most impressed by the new planting schemes at Golders Hill Park, when I walked round last week and by the beautifully reconstructed wall at Mawson's Hill Gardens".*

### **Corporate & Strategic Implications**

14. The planting design supports several of the City Together Strategy - The heart of World Class City 2008-2014 themes, including: *... supports our communities ... protects, promotes and enhances our environment ... is vibrant and culturally rich.*
15. The design proposal also shares the Open Spaces Department Business Plan 2012-2015 aims & objectives: *"Deliver sustainable working practice to promote the variety of life and protect the Open Spaces for future generations .. Manage, develop and empower a capable and motivated work force to achieve high standards of safety and performance".*
16. The planting design supports the Overriding Policy D1 in the Hampstead Heath Management Plan Part 1 – Towards a Plan for the Heath 2007-2017, *"Conserve and enhance the historic and planned elements of the Heath's designed landscapes, while improving their appearance and public facilities".*

## **Implications**

17. The costs associated with the implication of phases 1 and 2 of the sustainable perennial planting schemes have been met from the Superintendents local risk budget. The full saving of £55,000 that has contributed towards the budget reductions across the Division will be achieved during 2013/14.

## **Conclusion**

18. The sustainable planting scheme has been successful in uniting the different borders in the Walled Garden into a singular concept that flows seamlessly through the space and provides year round interest. Many of the plants which held their seed heads throughout the winter provided additional food sources for birds and habitats for invertebrates.
19. Gardening staff although initially disappointed with the proposed loss of seasonal bedding, have been totally committed from the initial design concept through to the implementation of the scheme. They have learned and gained new horticulture skills.
20. It is acknowledged that the Walled Garden in Golders Hill Park is a popular community facility used by local residents.

## **Appendices**

Appendix 1	Phase 1 - Season Photographs
Appendix 2	Phase 2 – Planting Plan
Appendix 3	Phase 2 - Planting List
Appendix 4	Golders Hill Sustainable Planting Parts 1 and 2

## **Contacts:**

*Simon Lee | [Simon.lee@cityoflondon.gov.uk](mailto:Simon.lee@cityoflondon.gov.uk) | 020 7332 3322*

*Declan Gallagher | [Declan.gallagher@cityoflondon.gov.uk](mailto:Declan.gallagher@cityoflondon.gov.uk) | 020 7332 3771*

*Adam Green | [Adam.Green@cityoflondon.gov.uk](mailto:Adam.Green@cityoflondon.gov.uk) | 020 73326652*



## Appendix 1 – Phase 1 Season Photographs

### Spring 2012 (Alliums in flower)



### Mid- Summer (Heuchera, Geraniums in flower and structured foliage plants)





Late Summer (Assortment of perennials in flower)





Winter 2012/13 (Frosted seed-heads)



## Appendix 2 – Phase 2 Planting Plan

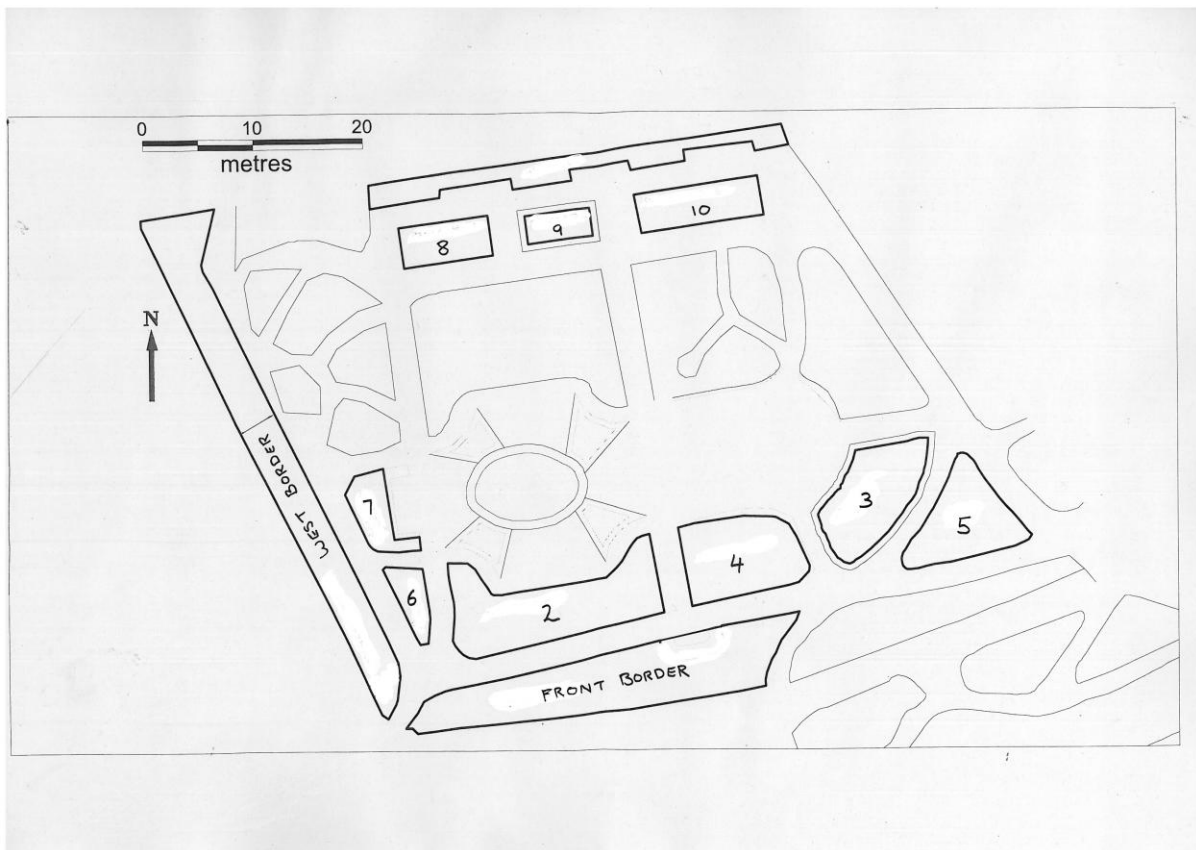



## Appendix 3 – Phase 2 Planting List

<p><b><u>Bed 2</u></b></p> <p><b>Blues</b>          Salvia “smouldering torches”          Perovskia “Blue spires”          Phlox “Blue paradise”          Rosa “Blue for you”          Agapanthus “Navy blue”          Eryngium planum “Blaukappe”          Aster “Little Carlow”          Agastache “Blue Fortune”          Agastache “Globetrotter”          Sedum “Bertram Anderson”          Geranium “Brookside”          Geranium “Orion”          Veronicastrum “Fascination”</p> <p><b>Oranges</b>          Rosa “Lady of Shallott”          Dahlia Catherine Deneuve          Crocosmia “Emily Mckenzie”          Crocosmia “Venus”          Hemerocallis “Bonanza”          Hemerocallis “Frans Hals”          Echinacea “White Swan”          Achillea “Inca Gold”          Libertia peregrinans</p> <p><b>Grasses</b>          Molinia “Transparent”</p> <p><b>Evergreen Groundcovers</b>          Stachys “silver Carpet”          Heuchera “Marmalade”          Heuchera “Southern Comfort”          Heuchera “Palace Purple”          Salvia purpurascens</p> <p><b>Bulbs</b>          Iris reticulate          Tulip “Ballerina”          Fritillaria imperialis Auroa orange          Allium azureum</p>	<p><b><u>Bed 3</u></b></p> <p><b>Pink/White</b>          Rosa “Spirit of Freedom”          Rosa “Raubritter”          Rosa “Louise Odier”          Rosa “Royal Jubilee”          Eupatorium “Orchard Dene”          Eryngium giganteum “Silver Ghost”          Sedum “September Glut”          Sedum “Matrona”          Sedum “Jose Aubergine”          Achillea “Pretty Belinda”          Hemerocallis “Catherine Woodbury”          Echinacea “Rosen Licht”          Echinacea “Rubenglow”          Echinacea “Fatal Attraction”          Rogersia “Chocolate Wings”          Veronicastrum virginicum “Album”</p> <p><b>Evergreen Groundcovers</b>          Stachys “Silver carpet”          Heuchera “Frosted Violet”          Salvia purpurascens</p> <p><b>Grasses</b>          Molinia “Transparent”</p> <p><b>Bulbs</b>          Galanthus nivalis          Galanthus nivalis “Flore pleno”          Tulip “Queen of the Night”          Tulip “Menton”          Allium “Pinball Wizard”          Nerine bodenii</p>
<p><b><u>Bed 4</u></b></p> <p><b>Red</b>          Achillea “Walter Funke”          Sedum “Red Cauli”          Crocosmia “Ember Glow”          Hemerocallis “Stafford”</p>	<p><b><u>Bed 5</u></b></p> <p><b>Red/Orange</b>          Rosa L D Braithwaite          Rosa “Dusky Maiden”          Sedum “Red Cauli”          Sedum “Jose Aubergine”</p>

Kniphofia "Lord Roberts"  
Lobelia "cardinalis"

**Orange**

Rosa "Lady Emma Hamilton"  
Hemerocallis "Frans Haals"  
Rudbeckia "Goldsturm"  
Achillea "Inca Gold"  
Crocasmia "Colombus"  
Libertia peregrinans  
Dahlia "Catherine Deneuve"  
Helenium "Mocheim Beauty"

**Groundcovers**

Stachys "Cotton Bol"  
Stachys "Silver Carpet"  
Heuchera "Sweet Tea"  
Heuchera "Caramel"  
Heuchera "Palace Purple"  
Salvia purpurea  
Ballota "pseudodictamnus"

**Grasses**

Molinia "Karl Foerster"

**Bulbs**

Fritillaria imperialis "Rubra Maxima"  
Tulip "Ballerina"

Dicentra "King of Hearts"  
Dicentra "Burning Hearts"  
Crocasmia "Babylon"  
Achillea "Red Velvet"  
Achillea "Walter Funcke"  
Hemerocallis Stafford  
Hemerocallis "Frans Hals"  
Kniphofia "Lord Roberts"  
Dahlia "Bishop of Llandaff"

**Evergreen Groundcovers**

Stachys "silver Carpet"  
Heuchera "Obsidian"  
Heuchera "Frosted violet"  
Heuchera "Blood red"  
Salvia purpurascens  
Ballota pseudodictamnus

**Grasses**

Molinia "Transparent"

**Bulbs**

Tulip (red)



**Bed 6**

Rosa "Lady of shallot" (Standard)  
Convolvulus sabatius  
Trachelium

**Grasses**

Molinia "Transparent"  
Molinia "Edith Dudzus"

**Bulb**

Tulip "Burgandy"

**Bed 7**

Panicum "Heavy Metal"  
Molinia "edith Dudzus"  
Dryopteris cristata "The King"  
Heuchera "Green Spice"  
Echinacea "Green Jewel"

**Bulb**

Tulip "Spring Green"

**Bed 8 (Pink, White and Blue)**

Rosa St swithun  
Hydrangea Annabelle  
Rogersia "Chocolate wings"  
Eupatorium "Orchard Dene2"  
Veronicastrum virginum "Album"  
Echinacea "Fatal attraction"  
Echinacea "white Swan"  
Anaphalis "Summer Snow"  
Actea "Brunnette"

**Evergreen Groundcovers**

Heuchera "Pewter Moon"  
Heuchera "Fire chief"  
Heuchera "Plum Pudding"  
Salvia purpurea  
Stachys "Silver carpet"

**Grasses**

Molinia "Karl Foester"

**Bulb**

Tulip "Greenland"

**Bed 9**

Rosa "Iceberg"  
Pulmanaria "Sissinghurst White"

**Bulb**

Tulip "salmon Impression"

**Bed 10**

Rosa "Charles Rennie Macintosh"  
Phlox "Franz Schubert"  
Veronicastrum "Fascination"  
Rogersia "chocolate Wings"  
Perovskia "Blue spire"  
Echinacea "fatal Attraction"  
Sedum matron  
Sedum "Jose Aubergine"

**Evergreen Groundcovers**

Heuchera "Frosted Violet"  
Heuchera "Sugar Plum"  
Heuchera "Shanghai"  
Salvia purpurea  
Stachys "Silver Carpet"

**Grasses**

Molinia "Transparent"

**Bulb**

Tulip "Negrita"